

Top View

SPECIFICATIONS

General information

- Panel weight : 5.66 lbs./ft² bare.
- 1" thick high density composite core.
- 1-1/16" inches deep with no covering.
- Protected from corrosion using a hot dipped galvanized top sheet and bottom pan.
- Class A flame spread rating.
- ULC File Number R16784

UNDERSTRUCTURE OPTIONS

- 2' Bolt-Tite Stringer Cornerlock
- 2' Snap-Tite Stringer
- 2' X 2' Heavy Duty Bolted Stringer
- 2' X 4' Heavy Duty Bolted Stringer
- 4' X 4' Heavy Duty Bolted Stringer

COVERING OPTIONS

Factory laminated with integral trim tile

- 1/16" HPL _____ Color _____
- 1/8" HPL _____ Color _____

For additional laminate options contact Inside Sales

Bare Panel Options

- Bare cornerlock to accept carpet tile application

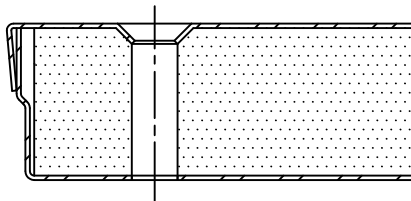

BARE CORNERLOCK VERSION

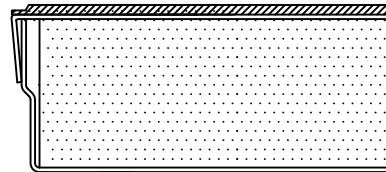

INTEGRAL TRIM VERSION

System Performance Criteria

System performance criteria are the most important to consider because they represent the performance in a typical installation. Panel only criteria such as concentrated load is often used to specify floor systems however, the test is not representative of an actual installation because it is performed with the panel resting on blocks, not actual understructure.

System Performance Criteria (Tested on Actual Understructure)							
System Type	Understructure	SYSTEM WEIGHT	STATIC LOADS		ROLLING LOADS		IMPACT LOADS
			Design* Loads	Safety Factor* (min. 2.0)	10 Passes	10,000 Passes	
WC5000/24"	Cornerlock	6.90 lbs / ft ²	1000 lbs	Pass	1000 lbs	700 lbs	150 lbs
	Snap-Tite Stringer / Bolt-Tite Stringer	7.40 lbs / ft ²	1000 lbs	Pass	1000 lbs	700 lbs	150 lbs
	Heavy Duty Bolted Stringer	7.60 lbs / ft ²	1250 lbs	Pass	1250 lbs	875 lbs	150 lbs

*Design loads and safety factors are defined in the Technical Resources/Technical Bulletins area of the web-site under "Design Loads". All other tests are conducted under CISCA's recommended test procedure for access floors.