

Tate[®] Wood Core 5000 FSC Air Seal Panel/24"

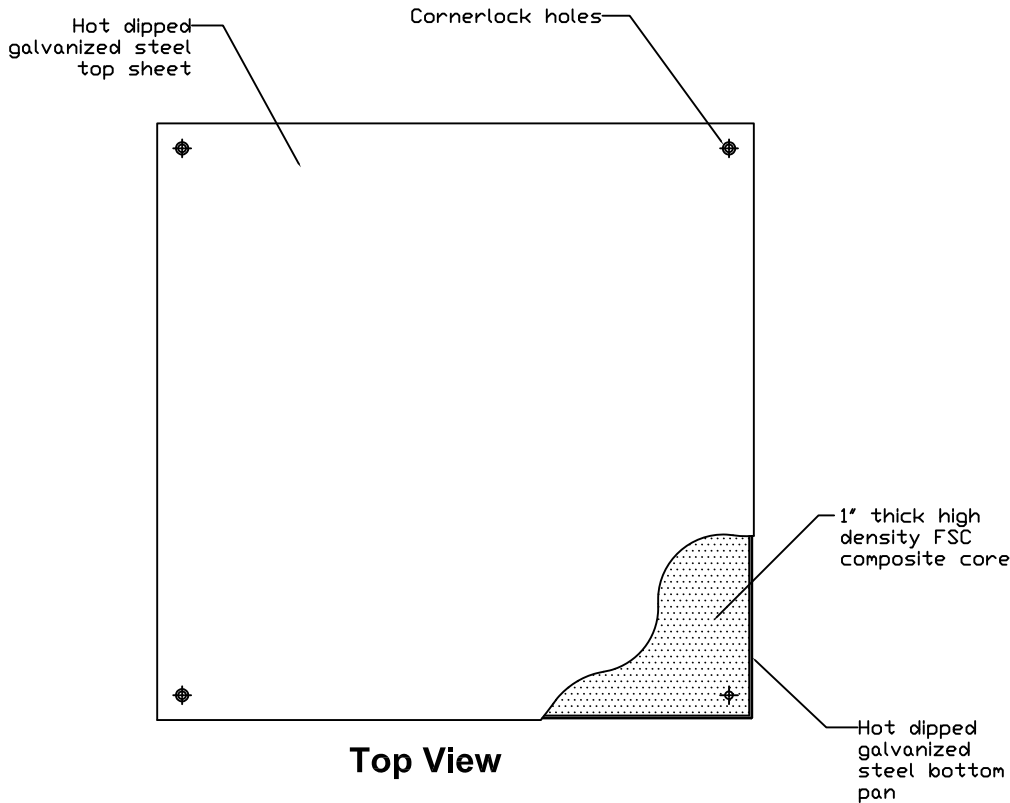

Top View

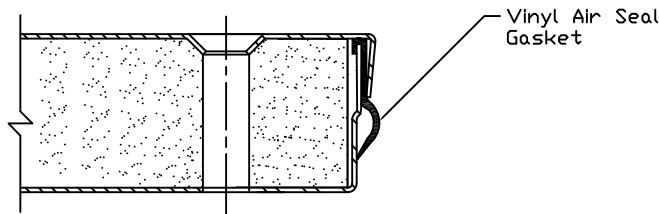

**BARE CORNERLOCK
SIDE VIEW**

SPECIFICATIONS

General information

- Panel weight : 5.66 lbs./ft² bare.
- 1" thick high density FSC composite core. Core is certified by the Forest Stewardship Council.
- 1-1/16" inches deep with no covering.
- Protected from corrosion using a hot dipped galvanized top sheet and bottom pan.
- Continuous vinyl air seal gasket mechanically attached to panel perimeter
- ULC File Number R16784

AIR LEAKAGE SPECIFICATION

- Average Leak Rate through Panel Seams not to exceed 0.10 CFM per linear ft. with 0.05-in w.g. static pressure in plenum.

UNDERSTRUCTURE

- Bare cornerlock to accept carpet tile application



The mark of responsible forestry

System Performance Criteria

System performance criteria are the most important to consider because they represent the performance in a typical installation. Panel only criteria such as concentrated load is often used to specify floor systems however, the test is not representative of an actual installation because it is performed with the panel resting on blocks, not actual understructure.

System Performance Criteria (Tested on Actual Understructure)							
System Type		SYSTEM WEIGHT	STATIC LOADS		ROLLING LOADS		IMPACT LOADS
Panel	Understructure		Design* Loads	Safety Factor* (min. 2.0)	10 Passes	10,000 Passes	
WC5000/24" FSC	Cornerlock	6.90 lbs / ft ²	1000 lbs	Pass	1000 lbs	700 lbs	150 lbs

*Design loads and safety factors are defined in the Technical Resources/Technical Bulletins area of the web-site under "Design Loads". All other tests are conducted under CISCA's recommended test procedure for access floors.