

TOP VIEW

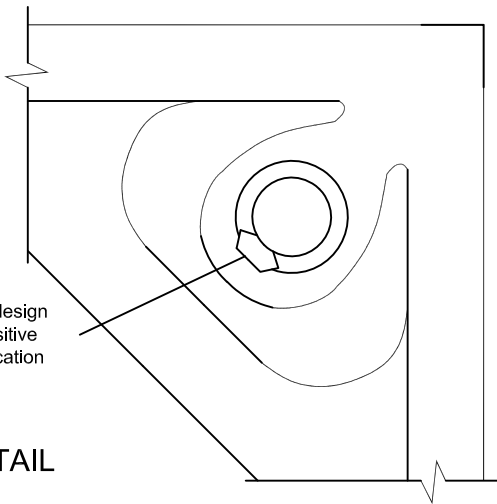

CORNER DETAIL

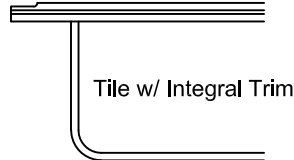
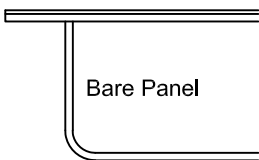

SPECIFICATIONS

General information

- Panel weight : 4.25 lbs./ft² bare.
- 1-3/8 inches deep with no covering.
- All steel welded construction.
- Protected from corrosion by an epoxy paint finish.
- Class A flame spread rating.
- Non-combustible material.

UNDERSTRUCTURE OPTIONS

- Freestanding Posilock
- 2' Bolted Stringer 4' Bolted Stringer

COVERING OPTIONS

Tile factory laminated with integral trim edge

- 1/8" HPL _____ (Color) _____
- 1/16" HPL _____ (Color) _____
- 1/8" Conductive HPL _____ (Color) _____
- 1/16" Conductive HPL _____ (Color) _____

For additional laminate options contact Inside Sales

Bare Painted Panel Options

- Bare Painted Finish to accept carpet tile application
- Bare Painted Finish to accept PosiTile application

System Performance Criteria

System performance criteria are the most important to consider because they represent the performance in a typical installation. Panel only criteria such as concentrated load is often used to specify floor systems however, the test is not representative of an actual installation because it is performed with the panel resting on blocks, not actual understructure.

| System Performance Criteria (Tested on Actual Understructure)* | | | | | | | |
|--|-----------------|---|--------------------|--------------------------|-------------------|-------------------|------------------|
| System Type | Understructure | SYSTEM WEIGHT | STATIC LOADS | | ROLLING LOADS | | IMPACT LOADS |
| | | | Design Loads | Safety Factor (min. 2.0) | 10 Passes | 10,000 Passes | |
| All Steel AS1000-24" | Posilock | 5.5 lbs / ft ² 27 kg / m ² | 1000 lbs 454 kg | Pass | 400 lbs 181 kg | 400 lbs 181 kg | 100 lbs 45 kg |
| | Bolted Stringer | 6.0 lbs / ft ² 30 kg / m ² | 1000 lbs 454 kg | Pass | 400 lbs 181 kg | 400 lbs 181 kg | 150 lbs 68 kg |

*System load definitions and test procedure descriptions can be found in the Standard Product Tests and Methodology Guidelocated in the Resources section of Tate's web-site, www.tateaccessfloors.com.